

Value600EI/Value1000EI/Value1200EILCD
Value1500EILCD/Value2200EILCD

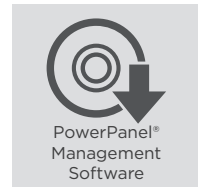

IEC SOCKETS FOR PROFESSIONAL USAGES

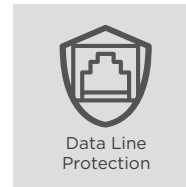
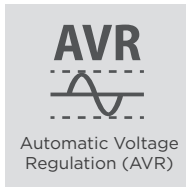
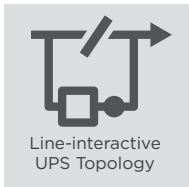

The Tower UPS providing reliable power protection with built-in Automatic Voltage Regulation for home and office

Ideal for home, SOHO office, office and back office applications, the Value Series adopts line-interactive topology with Automatic Voltage Regulation (AVR) function to offer stabilized AC power output. This series features IEC sockets for connections with PCs, laptops, and printers, etc. The included RJ11/RJ45 port can provide data line protection against surge and spike. The products' power management software achieves real-time monitoring and configuration.

APPLICATION

- Home
- Office
- SOHO Office
- Back Office

SERIES FEATURES

- Line-interactive UPS Topology
- Automatic Voltage Regulation (AVR)
- Surge and Spike Protection
- LCD Status Display*
- Tower Form Factor
- Energy Saving Technology*
- Overload Protection
- Phone/Fax/Modem/DSL/Network Protection
- PowerPanel® Management Software

*Selected Model(s)

PRODUCT CALLOUTS

1. Power On Indicator
2. Power On/Off Switch
3. LCD Display Panel
4. Function Button(s)
5. Battery Backup & Surge Protected Outlets
6. Communication Protection Ports RJ11/RJ45
7. Input Circuit Breaker

8. AC Inlet
9. USB Port
10. Serial Port

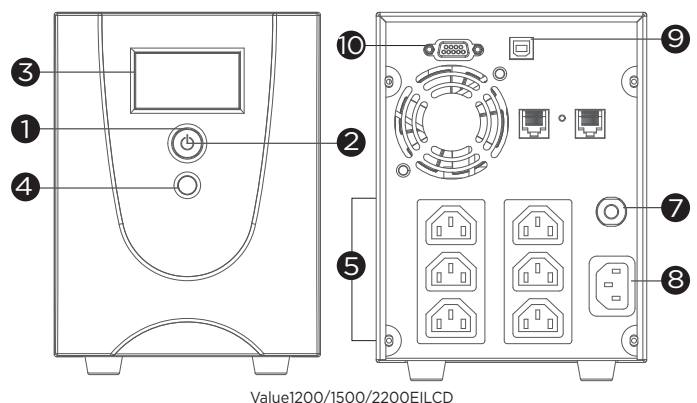
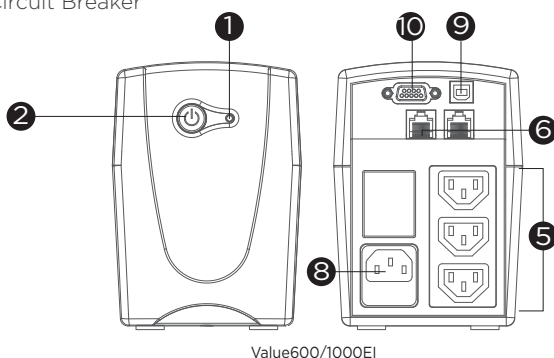



TECHNICAL SPECIFICATIONS

Model Name	Value600EI	Value1000EI	Value1200EILCD	Value1500EILCD	Value2200EILCD
General					
UPS Topology	Line-interactive	Line-interactive	Line-interactive	Line-interactive	Line-interactive
Energy Saving Technology	-	-	GreenPower UPS™ Bypass Technology		
Input					
Nominal Input Voltage (Vac)	230 ± 10%	230 ± 10%	230 ± 10%	230 ± 10%	230 ± 10%
Input Voltage Range (Vac)	165 - 280	165 - 280	165 - 280	165 - 280	165 - 280
Input Frequency (Hz)	50 ± 5, 60 ± 5	50 ± 5, 60 ± 5	50 ± 5, 60 ± 5	50 ± 5, 60 ± 5	50 ± 5, 60 ± 5
Input Frequency Detection	Auto-sensing	Auto-sensing	Auto-sensing	Auto-sensing	Auto-sensing
Rated Input Current (A)	2.72	4.55	5.45	6.82	10
Input Connector Type	IEC C14	IEC C14	IEC C14	IEC C14	IEC C14
Output					
Capacity (VA)	600	1000	1200	1500	2200
Capacity (Watts)	360	550	720	900	1320
On Battery Waveform	Simulated Sine Wave	Simulated Sine Wave	Simulated Sine Wave	Simulated Sine Wave	Simulated Sine Wave
On Battery Voltage(s) (Vac)	230 ± 10%	230 ± 10%	230 ± 10%	230 ± 10%	230 ± 10%
On Battery Frequency (Hz)	50 ± 1%, 60 ± 1%	50 ± 1%, 60 ± 1%	50 ± 1%, 60 ± 1%	50 ± 1%, 60 ± 1%	50 ± 1%, 60 ± 1%
Automatic Voltage Regulation (AVR)	Single Boost, Single Buck	Single Boost, Single Buck	Single Boost, Single Buck	Single Boost, Single Buck	Single Boost, Single Buck
Overload Protection	Fuse	Fuse	Circuit Breaker	Circuit Breaker	Circuit Breaker
Outlet(s) - Total	3	3	6	6	6
Outlet Type	IEC C13 x 3	IEC C13 x 3	IEC C13 x 6	IEC C13 x 6	IEC C13 x 6
Outlet(s) - Battery & Surge Protected	3	3	6	6	6
Typical Transfer Time (ms)	4	4	4	4	4
Battery					
Runtime at Half Load (min)	8	7	8	10	7
Runtime at Full Load (min)	1	1	2	2	1
Typical Recharge Time (Hours)	8	8	8	8	8
User Replaceable	No	No	Yes	Yes	Yes
Battery Type	Sealed Lead-acid	Sealed Lead-acid	Sealed Lead-acid	Sealed Lead-acid	Sealed Lead-acid
Replacement Battery Pack	-	-	RBPO084	RBPO085	RBPO086
RBP Quantity (pcs)	-	-	2	2	2
Surge Protection & Filtering					
Surge Suppression (Joules)	125	125	125	125	125
EMI/RFI Filtration	Yes	Yes	Yes	Yes	Yes
Phone/Network Protection RJ11/RJ45 (Combo)	1-in, 1-out	1-in, 1-out	1-in, 1-out	1-in, 1-out	1-in, 1-out
Management & Communications					
LCD Panel	-	-	Yes	Yes	Yes
LED Indicators	Power On, Line Mode, Battery Mode, Low Battery, Overload, UPS Fault		Power On		
HID Compliant USB Port(s)	1	1	1	1	1
Serial Port	RS232	RS232	RS232	RS232	RS232
Audible Alarms	Battery Mode, Low Battery, Overload, Overcharge, UPS Fault				
Power Management Software	PowerPanel® Personal Edition				
Physical					
Form Factor	Tower	Tower	Tower	Tower	Tower
Physical Size - UPS Module					
Dimensions (WxHxD) (mm.)	100 x 140 x 300	100 x 140 x 300	140 x 180 x 326	140 x 180 x 326	140 x 180 x 326
Weight (kg.)	4.6	5.5	11.2	13.2	14.5
Environmental					
Operating Temperature (°C)	0 - 40	0 - 40	0 - 40	0 - 40	0 - 40
Operating Relative Humidity (Non-condensing) (%)	0 - 90	0 - 90	0 - 90	0 - 90	0 - 90
Online Thermal Dissipation (BTU/hr)	99	109	167	198	225
Certifications					
Certifications*	CE, EAC	CE, EAC	CE, EAC	CE, EAC	CE, EAC
RoHS	Yes	Yes	Yes	Yes	Yes

*Certifications may vary according to different regions. Visit www.cyberpower.com for more information.
#All specifications are subject to change without notice.